

**T-Coupler M12 male / M12 female A-cod. V2A**

5-pol. / 2x 4-pol.

T-coupler

Male straight – females straight

M12 – M12, 5-pole

Distribution function (NO)

V2A nut/screw

Plastic housings with good resistance against chemicals and oils.

The resistance to aggressive media should be individually tested for your application. Further details on request.

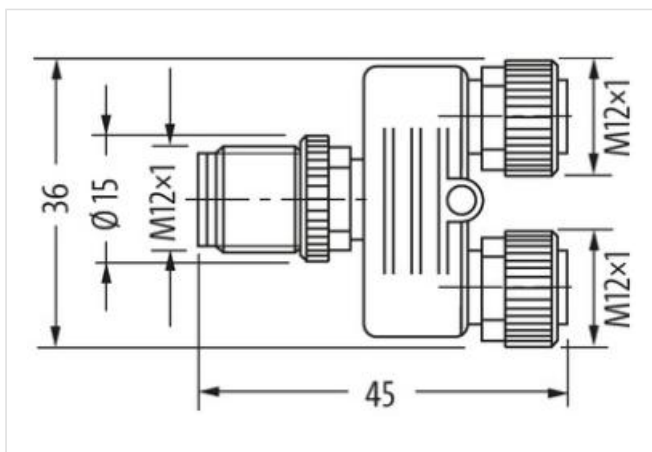
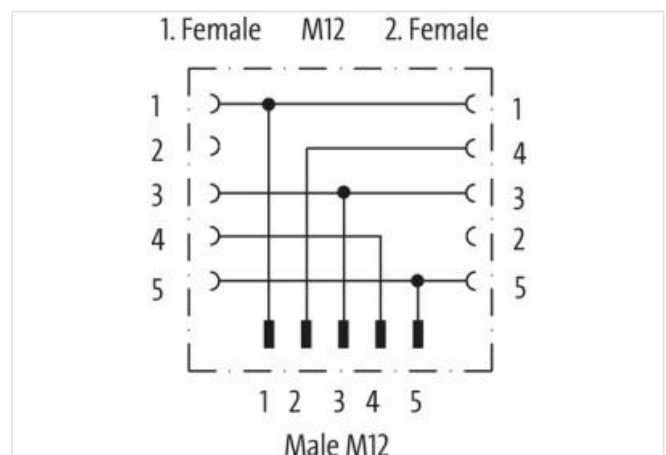
**[Link to Product](#)****Illustration**

Product may differ from Image

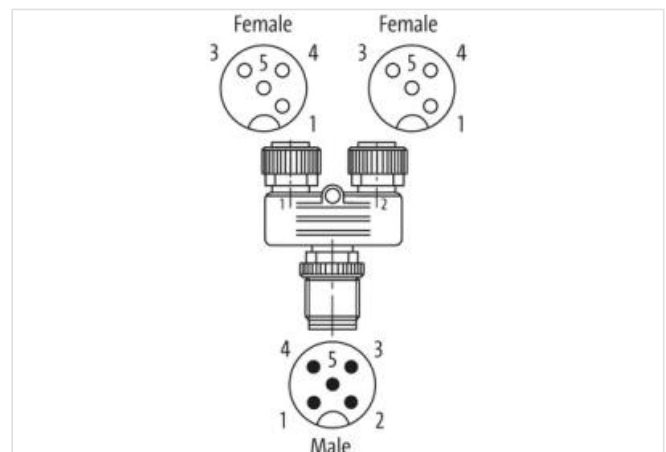
**Side 1**

Degree of protection (EN IEC 60529)

IP67

**Side 2**

Degree of protection (EN IEC 60529) IP67

#### Commercial data

ECLASS-6.0	27279221
ECLASS-6.1	27279221
ECLASS-7.0	27440104
ECLASS-8.0	27440104
ECLASS-9.0	27440106
ECLASS-10.1	27440106
ECLASS-11.1	27440106
ECLASS-12.0	27440106
ETIM-5.0	EC002635
customs tariff number	85366990
GTIN	4048879111775
Packaging unit	1

#### Electrical data | Supply

Operating voltage AC max.	60 V
Operating voltage DC max.	60 V
Current operating per contact max.	4 A

#### Installation | Connection

Tightening torque	0,6 Nm
Mounting set	M12 x 1

#### Device protection | Electrical

Additional condition protection degree	inserted, screwed
----------------------------------------	-------------------

#### Mechanical data | Material data

Locking material	Stainless steel 1.4305 (V2A)
------------------	------------------------------

#### Mechanical data | Mounting data

Mounting method	inserted, screwed, Shaking protection
-----------------	---------------------------------------

#### Environmental characteristics | Climatic

Operating temperature min.	-25 °C
Operating temperature max.	85 °C