

CAP BIG WITH PLUG. SCREW-TERM. 21-POLE

For use with 4-,6-,8-way d-box M12 5-pole

Cap for 4-, 6-, and 8-way distribution box, 5-pole  
Screw plug-in terminals  
Plastic housings with good resistance against chemicals and oils.  
The resistance to aggressive media should be individually tested for your application. Further details on request.

Link to Product

Illustration

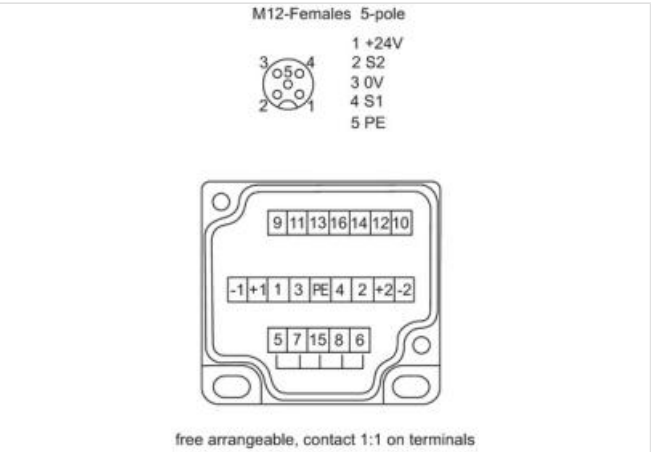
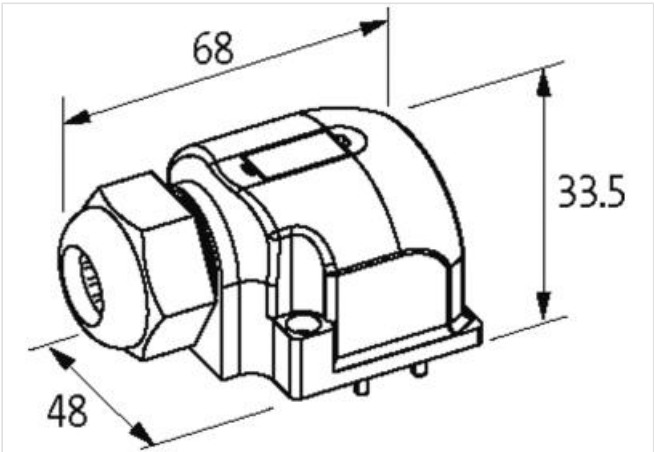

Product may differ from Image

Commercial data	
ECLASS-6.0	27143423
ECLASS-6.1	27279219
ECLASS-7.0	27279219
ECLASS-8.0	27279219
ECLASS-9.0	27440108
ECLASS-10.1	27440111
ECLASS-11.1	27440111
ECLASS-12.0	27440111
ETIM-5.0	EC002585
customs tariff number	85369010
GTIN	4048879058025

Packaging unit	1
----------------	---

**Electrical data | Supply**

Total current max.	8 A
--------------------	-----

**Installation**

Connection cross section max.	1,5 mm <sup>2</sup>
-------------------------------	---------------------

AWG number max.	16
-----------------	----

**Installation | Connection**

Connection	Screw plug-in terminals
------------	-------------------------

**Mechanical data | Mounting data**

Height	33,5 mm
--------	---------

Width	48 mm
-------	-------

Depth	68 mm
-------	-------

**Connection type 2**

Family construction form	Cap
--------------------------	-----

No. of poles	21
--------------	----

Family construction form	M12
--------------------------	-----

Gender	female
--------	--------

Color contact carrier	black
-----------------------	-------

Coding	A
--------	---

No. of poles	5
--------------	---

PIN 1	24 V DC
-------	---------

PIN 2	S 2
-------	-----

PIN 3	0 V
-------	-----

PIN 4	S 1
-------	-----

PIN 5	PE
-------	----