

CAP FOR D-BOX M12 8-WAY 5-POLE

No pot.-sep. 15m PUR/PVC-JB, 16x0,34+3x0,75

for 8-way distribution boxes, 5-pole  
PUR/PVC  
15.0 m

New Art.-No. 8000-88559-3981500

Plastic housings with good resistance against chemicals and oils.

The resistance to aggressive media should be individually tested for your application. Further details on request.

Link to Product

Illustration



Product may differ from Image

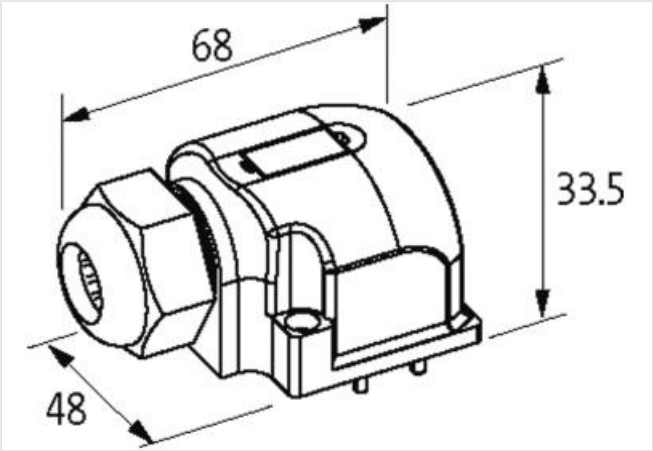

Commercial data

|                       |               |
|-----------------------|---------------|
| ECLASS-6.0            | 27143423      |
| ECLASS-7.0            | 27449001      |
| ECLASS-8.0            | 27449001      |
| ECLASS-9.0            | 27440321      |
| ETIM-5.0              | EC002585      |
| customs tariff number | 85444290      |
| GTIN                  | 4048879058308 |
| Packaging unit        | 1             |

Electrical data | Supply

|                    |     |
|--------------------|-----|
| Total current max. | 8 A |
|--------------------|-----|

Mechanical data | Mounting data

|        |       |
|--------|-------|
| Height | 33 mm |
| Width  | 48 mm |
| Depth  | 68 mm |

Installation | Cable

|                      |                                    |
|----------------------|------------------------------------|
| Cable identification | 398                                |
| Cable Type           | 2                                  |
| Jacket Color         | gray                               |
| Type of Certificate  | cURus                              |
| STOOW style jacket   | Hybrid, Signal, Power              |
| Amount stranding     | 1                                  |
| Stranding            | 7 wires around Core filler twisted |

|   |  |
|---|--|
| Amount stranding (type 2)                         | 1  |
| Stranding (type 2)                                | 12 wires around Stranding combination twisted  |
| wire arrangement                                  | white, gray-pink, brown-green, yellow, green-white, green, red-blue, (violet, brown-gray, black, gray-white, red, brown-yellow, pink, yellow-white, gray, blue, brown, green-yellow) |
| Cable weight                                      | 165 g/m  |
| Material jacket                                   | PUR  |
| Shore hardness jacket                             | 87 ± 5 Shore A   |
| Freedom from ingredients (jacket)                 | lead-free, cadmium-free, CFC-free, silicone-free   |
| Outer-diameter (jacket)                           | 10 mm  |
| Tolerance outer diameter (sheath)                 | ± 5 %  |
| Material inner jacket                             | PVC  |
| Color (inner jacket)                              | gray   |
| Material wire insulation                          | PVC  |
| Amount wires                                      | 16   |
| Outer diameter insulation                         | 1,3 mm   |
| Outer diameter tolerance core insulation          | ± 5 %  |
| Shore hardness wire insulation                    | 43 ± 5 Shore D   |
| Material properties wire insulation               | good machinability   |
| Ingredient freeness wire insulation               | lead-free, cadmium-free, CFC-free, silicone-free   |
| Amount strands (wire)                             | 19   |
| Diameter of single wires                          | 0,15 mm  |
| Conductor crosssection (wire)                     | 0,34 mm²   |
| Material conductor wire                           | Stranded copper wire, bare   |
| Conductor type (wire)                             | Strand class 5   |
| Material wire insulation (Power)                  | PVC  |
| Outer diameter wire insulation (Power)            | 1,8 mm   |
| Tolerance outer diameter wire insulation (Power)  | ±5 %   |
| Shore hardness wire insulation (Power)            | 43±5 Shore D   |
| Material properties wire insulation (Power)       | good machinability   |
| Ingredient freeness wire insulation (Power)       | lead-free, cadmium-free, CFC-free, silicone-free   |
| Amount strands wire (Power)                       | 42   |
| Diameter of single wires (Power)                  | 0,15 mm  |
| Wire conductor cross section (Power)              | 0,75 mm²   |
| Material conductor wire (Power)                   | Stranded copper wire, bare   |
| Conductor type wire (Power)                       | strand class 6   |
| Traversing distance (C-track)                     | 5 m @ 25 °C  |
| Travel speed (C-track)                            | 3  |
| Max. rated voltage (conductor - conductor)        | 300 V  |
| Max. rated voltage (conductor - ground)           | 300 V  |
| Current load capacity (standard)                  | to DIN VDE 0298-4  |
| Current load capacity min. wire                   | 4 A  |
| Electrical resistance line constant wire          | 57 Ω/km @ 20 °C  |
| Electrical resistance coating wire (Power)        | 26 Ω/km @20 °C   |
| AC withstand voltage (wire - wire)                | 2 kV @ 60 s  |
| Power frequency withstand voltage (wire - jacket) | 2 kV @ 60 s  |
| Loop resistance                                   | 7,8 A  |
| Min. operating temperature (static)               | -30 °C   |
| Max. operating temperature (fixed)                | 80 °C  |
| Operating temperature min. (dynamic)              | -5 °C  |
| Operating temperature max. (dynamic)              | 70 °C  |
| Flame resistance                                  | IEC 60332-2-2   UL 1581 § 1090   UL 1581 § 1100 FT2  |
| chemical resistance                               | Good, application-related testing  |
| Gasoline resistance                               | Good, application-related testing  |

|                                 |  |
|---------------------------------|--|
| Oil resistance                  | Good, application-related testing   DIN EN 60811-404 |
| Bending radius (fixed)          | 5 x Outer diameter                                   |
| Bending radius (dynamic)        | 10 x Outer diameter                                  |
| No. of bending cycles (C-track) | 2 Mio. @ 25 °C                                       |

#### Connection type 2

|                          |                |
|--------------------------|----------------|
| Family construction form | M12            |
| Gender                   | female         |
| Color contact carrier    | black          |
| Coding                   | A              |
| No. of poles             | 5              |
| PIN 1                    | +              |
| PIN 2                    | NC S 2         |
| PIN 3                    | -              |
| PIN 4                    | NO S 1         |
| PIN 5                    | PE             |
| Connection type 1        | X1-X8          |
| Family construction form | free cable end |
| Color contact carrier    | gray           |
| No. of poles             | 19             |
| Family construction form | M12            |
| Gender                   | female         |
| Color contact carrier    | black          |
| Coding                   | A              |
| No. of poles             | 5              |
| PIN 1                    | +              |
| PIN 2                    | NC S 2         |
| PIN 3                    | -              |
| PIN 4                    | NO S 1         |
| PIN 5                    | PE             |
| Family construction form | free cable end |
| Color contact carrier    | gray           |
| No. of poles             | 19             |